

# The Original

Lankhorst KLP® Range

2011



[www.lankhorst.co.uk](http://www.lankhorst.co.uk)

Lankhorst | *Recycled Products UK Ltd*



## LANKHORST KLP® RANGE – JANUARY 2011

Lankhorst Recycling Products BV have been making high quality sustainable products from recycled plastic for more than 35 years.



KLP®, the brand name for our products, stands for quality and durability.

The Lankhorst KLP® Range contains all our standard products as of January 2011.

### Sales conditions

Our sales conditions are filed at the Office of the District Court in Leeuwarden, The Netherlands and printed on the reverse of this edition of the Lankhorst KLP® Range.

### Dimensional tolerances

The dimensions specified in this edition of the Lankhorst KLP® Range are the global production sizes for the respective articles. All articles made by Lankhorst Recycling Products have a dimensional tolerance of  $\pm 2\%$ .

### Quality

Improvements in the quality of construction and/or design can be implemented without prior notification. Slight colour variations can occur between articles from different production batches. Unless specified otherwise, the product colour is KLP® black. Other colours (including grey, brown, green and white) are available on request.

### Information

To request specific or additional product information, please use the digital form on our website:

[www.lankhorst.co.uk](http://www.lankhorst.co.uk)

---

### Sales department United Kingdom:

FREE PHONE

0800 043 0880

General fax no.

+31 (0) 515 - 487495

[sales@lankhorst.co.uk](mailto:sales@lankhorst.co.uk)

[www.lankhorst.co.uk](http://www.lankhorst.co.uk)

### Direct lines:

Carl North

UK Sales Manager

07900 212 837

[c.north@lankhorst.co.uk](mailto:c.north@lankhorst.co.uk)

Alex Bragg

Area Sales Manager

07917 390 474

[a.bragg@lankhorst.co.uk](mailto:a.bragg@lankhorst.co.uk)

Astrid Wijninga

Sales support

+31 (0) 515 - 487630

[ukoffice@lankhorst-recycling.nl](mailto:ukoffice@lankhorst-recycling.nl)

Janneke Hiemstra

Sales support

+31 (0) 515 - 487630

[ukoffice@lankhorst-recycling.nl](mailto:ukoffice@lankhorst-recycling.nl)

Ellen van den Ende

Sales support

+31 (0) 515 - 487630

[ukoffice@lankhorst-recycling.nl](mailto:ukoffice@lankhorst-recycling.nl)

Janke Veenstra

Sales support

+31 (0) 515 - 487630

[ukoffice@lankhorst-recycling.nl](mailto:ukoffice@lankhorst-recycling.nl)

Cora Vlieger

Marketing support

+31 (0) 515 - 487677

[ukoffice@lankhorst-recycling.nl](mailto:ukoffice@lankhorst-recycling.nl)

Copyright Lankhorst Recycling Products.

Subject to printing errors.

This edition of the Lankhorst KLP® Range replaces all previous publications.

January 2011

## KLP<sup>®</sup> BOLLARDS

### KLP<sup>®</sup> DIAMOND-HEAD BOLLARDS

#### Without bevelled edges

Article code	Dimensions
233788	10 x 10 x 120 cm
233787	10 x 10 x 160 cm
231932	12 x 12 x 140 cm
233783	7.5 x 7.5 x 135 cm

#### With bevelled edges

233803	15 x 15 x 140 cm
--------	------------------

### KLP<sup>®</sup> H-DIAMOND-HEAD BOLLARDS WITH BEVELLED EDGES, HIGH STRENGTH

Article code	Dimensions
233793	15 x 15 x 120 cm
233807	15 x 15 x 140 cm
233813	15 x 15 x 160 cm

White	
233808	15 x 15 x 140 cm

#### 2 milled-in reflecting strips

Article code	Dimensions
233799	15 x 15 x 120 cm
233806	15 x 15 x 140 cm
233826	15 x 15 x 160 cm

White	
233809	15 x 15 x 140 cm

#### 2 milled-in reflecting strips, anchor hole and anchor bar

Article code	Dimensions
233804	15 x 15 x 140 cm

#### Optional extras for diamond-head bollards

- Milled-in prism reflector 18 x 4 cm
- Anchor hole (A)
- Anchor bar
- Reflective band 20 mm
- Reflective band 48 mm
- Cutting price

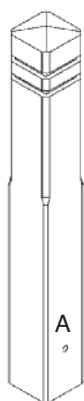

### KLP<sup>®</sup> REMOVABLE DIAMOND-HEAD BOLLARD

Article code	Dimensions
233840	15 x 15 x 80 cm with lock mechanism, hexagonal hook spanner, with 2 milled-in reflecting strips, without concrete base
231804	concrete base

### KLP<sup>®</sup> OCTAGONAL ORNAMENTAL BOLLARDS

Article code	Dimensions
black	
234697	15 x 50 cm*
233705	15 x 82 cm*

grey	
233698	15 x 50 cm*
233704	15 x 82 cm*

\* the foundation (A) foot of 48 cm underground is not included in this length.

### KLP<sup>®</sup> REMOVABLE OCTAGONAL ORNAMENTAL BOLLARDS

Article code	Dimensions
233703	15 x 82 cm black
233707	15 x 82 cm grey with lock mechanism, hexagonal hook spanner, without concrete base
231804	concrete base

### KLP<sup>®</sup> DOME-HEAD BOLLARD

Article code	Dimensions
233702	15 x 140 cm

### KLP<sup>®</sup> MANCHESTER BOLLARD (BLACK)

Article code	Dimensions
233715	13 x 125 cm

### KLP<sup>®</sup> ROUND BOLLARDS WITH BASE POINT

#### Chamfered top

Article code	Dimensions
231924	6.5 x 150 cm
231836	7.5 x 150 cm
231838	7.5 x 180 cm
231854	9.5 x 160 cm
231850	9.5 x 200 cm
230260	10 x 120 cm
230092	10 x 300 cm
231794	15 x 160 cm

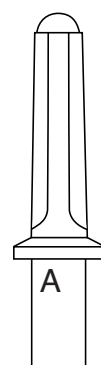
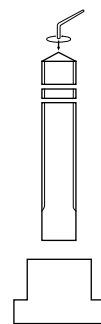

**KLP<sup>®</sup> ROUND POSTS  
EXCLUDING BASE POINT**

**Chamfered top**

Article code	Dimensions
230113	15 x 300 cm
230111	15 x 363 cm

**KLP<sup>®</sup> SQUARE POSTS INCLUDING BASE POINT**

**Chamfered top**

Article code	Dimensions
230057	4.3 x 4.3 x 150 cm
230065	4.3 x 4.3 x 185 cm
230022	5.3 x 5.3 x 150 cm
230030	5.3 x 5.3 x 185 cm
230235	7 x 7 x 160 cm
230138	7 x 7 x 200 cm
231827	8 x 8 x 160 cm
231824	8 x 8 x 200 cm
231826	8 x 8 x 250 cm
230316	10 x 10 x 120 cm
230154	10 x 10 x 160 cm
230155	10 x 10 x 180 cm
230049	10 x 10 x 215 cm
230148	10 x 10 x 250 cm
230146	10 x 10 x 300 cm

**KLP<sup>®</sup> -S STEELREINFORCED BEAM**

Article code	Dimensions
240119	8 x 8 x 250 cm
240121	8 x 8 x 300 cm

**KLP<sup>®</sup> PLANKS AND BEAMS**

**KLP<sup>®</sup> PLANKS AND BEAMS  
EXCLUDING BASE POINT**

Article code	Dimensions
231981	6 x 2 x 250 cm
231909	10 x 2.5 x 250 cm
231894	10 x 3 x 250 cm
231897	10 x 3 x 300 cm
231990	15 x 3 x 300 cm
232680	7 x 4 x 250 cm
232392	12 x 4 x 200 cm
231898	14 x 4 x 300 cm
231913	20 x 4 x 325 cm
231901	10 x 5 x 200 cm
232421	15 x 5 x 200 cm
232398	15 x 5 x 250 cm

231899	15 x 5 x 325 cm
231880	12 x 6 x 200 cm
231940	12 x 6 x 300 cm
231002	7 x 7 x 250 cm
231029	15 x 7 x 250 cm
231030	16 x 8 x 360 cm
232390	10 x 10 x 300 cm

**KLP<sup>®</sup> SIGNAL POSTS**

**With two recess's**

Article code	Dimensions
230200	13 x 4 x 120 cm
231623	15 x 4 x 120 cm

**KLP<sup>®</sup> MARKER POST**

**With one recess**

Article code	Dimensions
233327	12 x 12 x 140 cm

**KLP<sup>®</sup> TONGUE-AND-GROOVE PANELLING**

Article code	Dimensions
Black	
232142	14 x 2.8 x 250 cm
232140	14 x 3.2 x 250 cm
232125	14 x 3.8 x 264 cm
231139	15 x 2 x 250 cm
Brown	
232136	14 x 2.8 x 250 cm
232138	14 x 3.2 x 250 cm
232127	14 x 3.8 x 264 cm

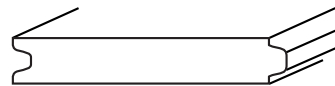

Green	
232132	14 x 2.8 x 250 cm
232139	14 x 3.2 x 250 cm
232126	14 x 3.8 x 264 cm

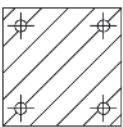
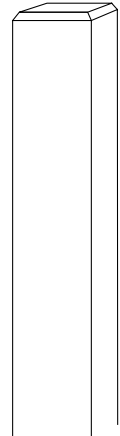

## KLP<sup>®</sup> GROUND REINFORCEMENT PRODUCTS

### KLP<sup>®</sup> ECOGRID

Article code	Dimensions
231815 (E50)	33.3 x 33.3 x 5 cm
231820 (S50)	33.3 x 33.3 x 5 cm
240994 (EH40)	33.3 x 33.3 x 4 cm
240997 (EL30)	33.3 x 33.3 x 3 cm

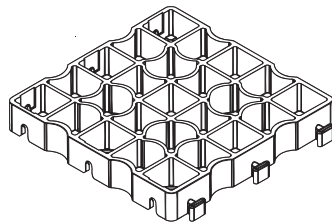

Standard colour is black, green is available on request. Delivered as pre-assembled sheets of 4x3=12 grid panels. The maximum axle load is 20 tonnes. Parking space markers / bends available on request.

## KLP<sup>®</sup> STREET FURNITURE

### KLP<sup>®</sup> PICNIC SET 2 BENCHES

Article code (200 cm / 250 cm)	Colour
242396/242410	black
242399/242414	grey
242395/242412	brown

To be anchored, but also available as stand alone. Planks are reinforced with steel strip. Standard colour of the frame is black.

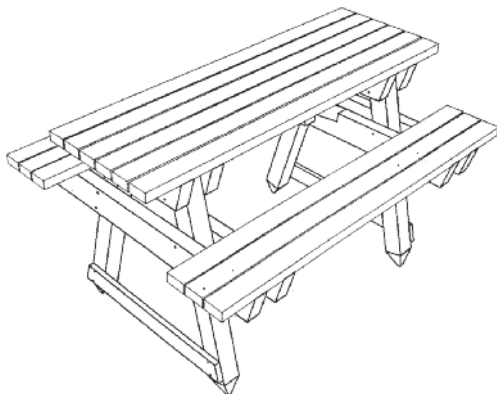

### KLP<sup>®</sup> PICNIC SET 4 BENCHES

Article code	Colour
240801	black
240802	grey
240800	brown

To be anchored. Standard colour of the frame is black. All picnic sets are pre-assembled before delivery.

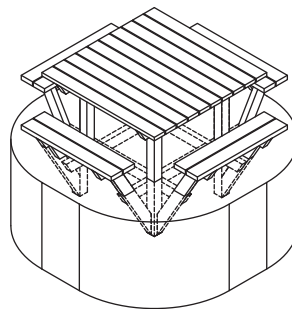

Picnic set  
4 benches

## NEW AND IMPROVED DESIGN! KLP<sup>®</sup> BENCHES WITH STEEL SUPPORT

Article code	Description
242397	black
242377	grey
242387	brown

Benches are supplied as construction kits with pre-drilled holes and galvanised carriage bolts. Black frame and cross piece for support. The planks are reinforced with steel strips.

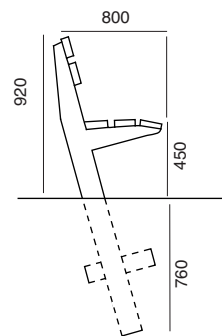

## KLP<sup>®</sup> BENCH PLANKS WITH STEEL STRIPS

Article code	Dimensions
242886 black	12 x 4 x 180 cm
242887 grey	12 x 4 x 180 cm
242317 brown	12 x 4 x 180 cm
242901 black	10 x 5 x 200 cm
242902 grey	10 x 5 x 200 cm
242110 brown	10 x 5 x 200 cm

Planks are reinforced with steel strip.

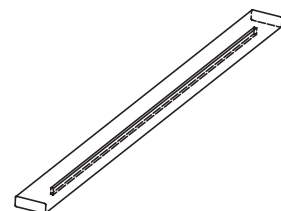

## KLP<sup>®</sup> MARINE CONSTRUCTION & CIVIL ENGINEERING PRODUCTS

KLP<sup>®</sup> Products are ideal for marine construction & civil engineering projects. For example: Landing stages, decking, walkways and bridges. The components listed below can also be used for the superstructure. Ask our product specialists about the possibilities

### KLP<sup>®</sup> LANDING STAGES & JETTIES

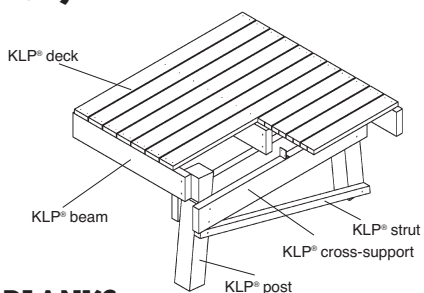

#### KLP<sup>®</sup> DECK PLANKS With profile

##### black

Article code	Dimensions
233877	15 x 3 x 300 cm
233886	18 x 3.9 x 325 cm
233889	20 x 4.7 x 325 cm

##### grey

Article code	Dimensions
243877	15 x 3 x 300 cm
243887	18 x 3.9 x 325 cm
243889	20 x 4.7 x 325 cm

##### brown

Article code	Dimensions
233878	15 x 3 x 300 cm
233887	18 x 3.9 x 325 cm
233890	20 x 4.7 x 325 cm

#### KLP<sup>®</sup>-S STEEL REINFORCED (CROSS-) BEAMS

Dimensions	Maximum length
15 x 7 cm	275 cm
16 x 8 cm	400 cm
18 x 8 cm	500 cm
25 x 20 cm	450 cm
25 x 15 cm	520 cm

Different steel diameters available.

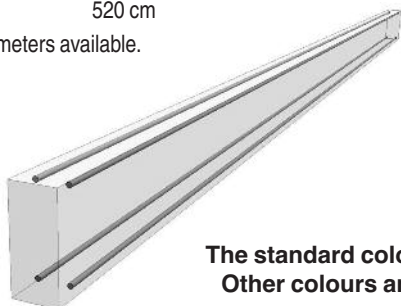

#### KLP<sup>®</sup>-S I-BEAM (STEEL REINFORCED)

Article code	Dimensions
240141	13 x 7 x 400 cm

Steel reinforcing suitable for various applications is available in different diameters. Ask our product specialists about the possibilities or check our technical brochure for specific load capacities.

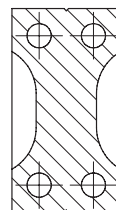

#### KLP<sup>®</sup> CONSTRUCTION POSTS

Available as round (Ø 16 cm) or square (15 x 15 cm) posts with lengths up to 1500 cm. Standard colour grey.

#### KLP<sup>®</sup> PILE HEADS

Plastic pile heads for use in combination with timber posts

Description	Dimension
Pilehead small	Ø18.5 x 50 cm/ 20 x 20 x 70
Pilehead medium	Ø18.5 x 50 cm/20 x 20 x 120
Pilehead large	Ø18.5 x 50 cm/20 x 20 x 150

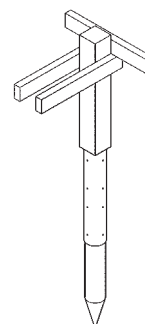

#### KLP<sup>®</sup> BRIDGES & WALKWAYS

##### KLP<sup>®</sup> TYPE MODULAR

Length:	max. 5 metres per module
Width:	on demand

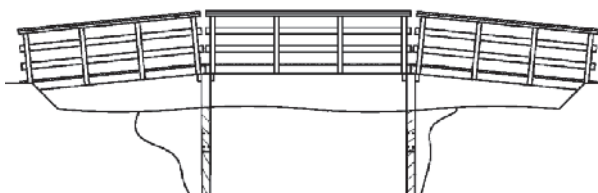

##### KLP<sup>®</sup> TYPE ARCHED SUSPENSION BRIDGE

Length:	max. 12 metres single span
Width:	on demand

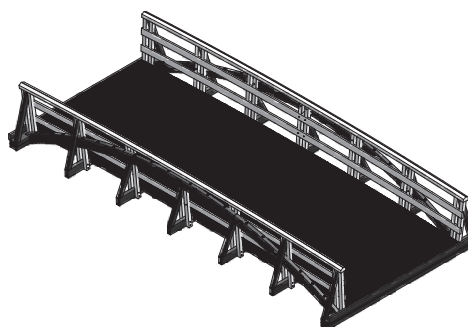

Delivered as a prefabricated unit on request. Calculations according to NEN 6702 or NEN 6706.

## KLP<sup>®</sup> HANDRAILS

### Reinforced

Article code	Dimensions	
240018	10 x 10 x 120 cm	Balustrade
240010	14 x 4 x 520 cm	Edge rail
240006	14 x 10 x 520 cm	Hand rail
237070	13 x 5 x 400 cm	Hand rail

Mentioned article codes apply to the standard colour white.

Black available on request.

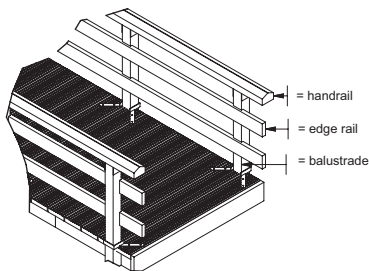

## KLP<sup>®</sup> PROWAL

### Prefabricated assembled tongue-and-groove sheet piling

Article code	Dimensions
230791	45 x 2 x 250 cm
230792	60 x 2 x 250 cm
230788	75 x 2 x 250 cm
230789	90 x 2 x 250 cm

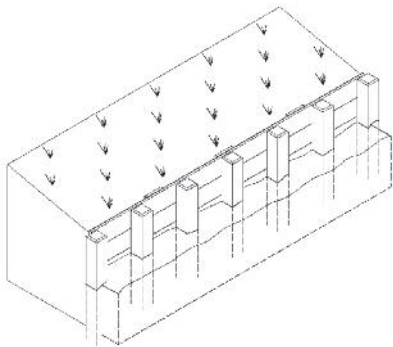

## KLP<sup>®</sup> RIGID POSTS INCLUDING BASE POINT

### Glass fibre reinforced (E-cast approx. 2000 N/mm<sup>2</sup>)

Article code	Dimensions
231795	Ø 9.5 x 200 cm
231803	Ø 9.5 x 250 cm
231822	8 x 8 x 160 cm
231248	8 x 8 x 200 cm
231249	8 x 8 x 250 cm
230157	10 x 10 x 180 cm
231823	10 x 10 x 215 cm
231825	10 x 10 x 250 cm
231829	10 x 10 x 300 cm

## KLP<sup>®</sup> COMBIPOSTS INCLUDING BASE POINT

Pine timber post with a KLP<sup>®</sup> top section. Size top section:

Ø 11 x 75 cm. Combiposts are available in various sizes.

## KLP<sup>®</sup> COMBI PILE PLANKING (RETAINING WALL)

Article code	Dimensions	Description
240318	22.5 x 8/12 x 600 cm	Tongue & Groove retaining wall plank
240316	15 x 16 x 500 cm	Steel reinforced fender

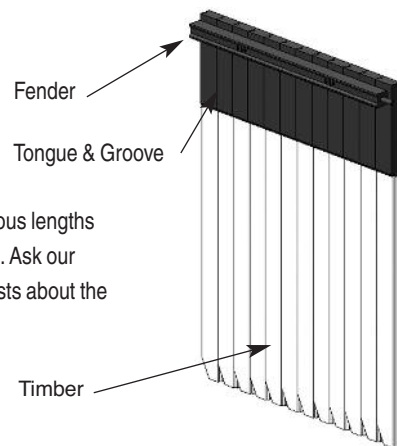

Available in various lengths and thicknesses. Ask our product specialists about the possibilities.

## KLP<sup>®</sup> PILE PLANKING (RETAINING WALL)

Article code	Dimensions	Description
240322	20 x 5 x 300 cm	Glass fibre reinforced Tongue & Groove
240119	8 x 8 x 250 cm	Steel reinforced fender
241829	10 x 10 x 300 cm	Glass fibre reinforced fender

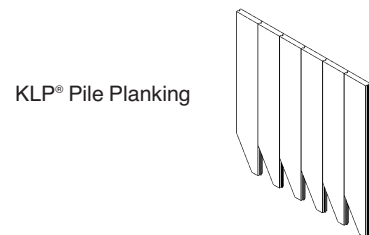

KLP<sup>®</sup> Pile Planking

## KLP<sup>®</sup> PE COMPOUND GIRDERS AND MARINE FENDERS

Article code	Dimensions	To fit
232307	25 x 15 x 250 cm	UNP 280
232315	25 x 15 x 295 cm	UNP 280
232317	15 x 10 x 450 cm	
232899	16 x 8 x 360 cm	
232320	20 x 10 x 400 cm	UNP 220

Without mounting holes and steel profile.

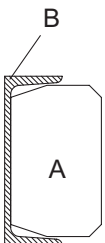

A =  
KLP<sup>®</sup> Fender  
B = UNP  
steel profile

**EXTRACT FROM THE GENERAL CONDITIONS**  
**of**  
**LANKHORST SNEEK B.V.,**

domiciled at Sneek, Prinsengracht 2, as well as of the companies belonging to Lankhorst Sneek B.V.:  
Lankhorst Touwfabrieken B.V.; Lankhorst Pure Composites B.V.; Lankhorst Engineered Products B.V.; Lankhorst Mouldings B.V.;  
Lankhorst Recycling Products B.V.; Noord Nederland Recycling B.V.; Ekon B.V.; Lankhorst Taselaar B.V.; Lankhorst Hohorst B.V.;  
Lankhorst Indutech Cerfil B.V.; Terschellinger Zeemanshandwerk B.V.; Euro Rope and Netting Trading B.V.

The conditions set forth hereinafter are only an extract from the general conditions of Lankhorst Sneek B.V. and companies belonging to it. The general conditions referred to, deposited with the Chamber of Commerce Noord-Nederland on 18 June 2009 under number 01010325, are applicable to all offers from, orders to, agreements with and deliveries by the private limited company Lankhorst Sneek B.V. and/or the companies belonging to it, to be jointly referred to hereinafter as: "we" or "us". The purpose of this extract is to give an impression of the stipulations of the general conditions. No rights shall be derived from the fact that an article is either included in this extract or not. In assessing the rights of parties exclusively the text of the integral general conditions shall be relevant, unless the conditions are not binding upon the other party; in that case the stipulations of the extract shall apply.

**1. GENERAL**

The applicability of any general conditions used by the other party is explicitly ruled out. Any stipulations deviating from the present conditions shall only apply if and insofar as such stipulations have been explicitly accepted by us in writing.

**2. OFFERS**

All offers submitted shall remain valid for a period to be specified by us. If such period is lacking, our offers shall free of engagement. We reserve the right to cancel orders without stating any reasons or to supply cash on delivery.

**3. AGREEMENT**

An agreement with us shall only be realised when we have accepted respectively confirmed an order in writing. In respect of operations for which, in view of their nature and size, no offer or confirmation of an order is sent, the agreement shall be deemed to have been realised at the moment when we have commenced actual execution thereof. When entering or after having entered into an agreement, we shall have the right, before commencing or continuing performance, to demand security from the other party that both financial and other obligations shall be fulfilled.

**4. PRICES**

All quotations are made subject to price changes, unless otherwise stated. In case of an increase in one or more cost price elements, we shall have the right to increase the price of the order accordingly, duly observing any relevant statutory regulations.

**5. PROTECTION OF RIGHTS**

Offers and/or catalogues and/or drawings, etc. made available by us as well as the appendices, which may be the subject of any intellectual and/or industrial property rights or of any other rights to be put on a par with such rights, shall remain our property. In case that objects are manufactured after drawings, models, samples or other instructions, in the widest sense of the word, received from the other party, the other party shall give full guarantee that by manufacture and/or supply of such objects no brand name, patent, application or trade model or any other right of third parties is violated and indemnify us against all claims from any third party.

**6. DELIVERY AND TIME OF DELIVERY**

Unless otherwise agreed upon, delivery shall take place off works. The time of delivery shall be deemed to be the moment when the objects have been made available to the other party at our site for transport to or for the other party. Exceeding a time of delivery shall not oblige us to provide any compensation. In case that the time of delivery is exceeded, otherwise than due to force majeure or through the other party's whether or not culpable fault, the other party shall have the right to stipulate another period of delivery to us in writing. In case of non-observance of the latter period, the other party shall have the right to rescind the agreement, insofar as not yet performed, by means of a notification in writing.

**7. TRANSPORT/RISK**

Transport of objects shall take place at all times for the account and at the risk of the other party.

**8. FORCE MAJEURE (NON-IMPUGNABLE DEFAULT)**

A case of force majeure on our part arises if performance of the agreement is fully or partly prevented -whether or not temporarily- due to circumstances beyond our control and on account of which fulfillment of the agreement can in fairness no longer be demanded from us by the other party. In the event that force majeure continues for more than thirty days, either party shall have the right to suspend performance of the agreement fully or partly, for the part affected by

the force majeure, or to rescind the agreement fully or partly by means of a notification in writing, without being obliged to provide any compensation related thereto on any account whatsoever.

**9. LIABILITY**

We shall never be obliged to provide any compensation for damage, of whatever nature, either direct or indirect, including loss of profits, damage to movable properties, real estate, or injury to persons, at the side of both the other party and third parties. All and any except for wilfulness or gross negligence, which is to be proved by the other party, committed by ourselves or by those for whom we are liable. In the event that we are obliged to provide any compensation, the compensation shall never exceed a sum equal to the invoice value of the defective objects due to which the damage was caused. In case of partial deliveries, the maximum compensation we shall be obliged to pay is the relevant part of the invoice amount.

**10. COMPLAINTS**

Complaints concerning externally visible defects of the objects delivered and/or the packaging, shall be submitted within eight days from delivery at the latest. Complaints concerning defects not externally visible shall be submitted to us in writing and as soon as possible after discovery thereof, but in any case within six months from delivery of the objects, exactly stating the nature of and the grounds for the complaints. Complaints concerning invoices shall be submitted in writing within eight days from the date of despatch of the invoices.

**11. WARRANTY**

No warranty shall be given on (parts of) objects and materials manufactured by us, unless explicitly otherwise agreed upon. Any right to a warranty shall be cancelled if the other party does not or not timely fulfil his obligations ensuing from the agreement entered into with us.

**12. RESERVATION OF OWNERSHIP**

The ownership of the objects to be delivered rests with us and shall only be transferred to the other party after full payment by the other party of all that which we hold as claim on the other party as *quid pro qua*, pursuant to the agreement, for objects delivered, as well as on account of deficiencies in the observance of such agreement, damage, costs and interest being included therein. The other party shall not have the right to alienate objects subject to the reservation of ownership or to grant any limited right thereto to third parties.

**13. PAYMENT**

Unless otherwise agreed upon in writing, payment shall be effected within thirty days from the date of invoice, without any deduction or a deduction of any amount payable by us being made, either in cash or into one of our bank/giro accounts.

**14. INTEREST AND COSTS**

As from the day on which the other party is in default making a payment to us, he shall owe to us a delay interest of 1½ % per month or a part of the month during which his default continues. All costs in and out of court to be incurred by us shall be for the account of the other party.

**15. APPLICABLE LAW AND DISPUTES**

Dutch law shall be applicable to the agreements to be entered into pursuant to these general conditions. All disputes shall be decided by the competent civil law court whose jurisdiction includes the town of Sneek where our principal company is domiciled, unless we wish to submit the dispute to the civil law court which is competent in accordance with the normal rules of competence or to cause the dispute to be settled by means of arbitration or a binding advice.



**Lankhorst Recycled Products UK Ltd**

P.O. Box 378 – Worsley - Manchester – M28 7YW  
Telephone 0800 043 0880 - Fax +31 (0) 515 487 495

E-mail: sales@lankhorst.co.uk - Internet: www.lankhorst.co.uk

Lankhorst Recycled Products is part of the Royal Lankhorst Euronete Group. www.lankhorsteuronete.com

